

Case Number: **130713**

21 December 2012

IIDAME PTY LTD
c/- JOHN M DALY & ASSOCIATES

FEASIBILITY LETTER

Developer: IIDAME PTY LTD
Your reference: 12253
Development: Lot 1113 2728 2030, Oxford Falls Rd, Oxford Falls
Development Description: 150 room aged care Facility
Your application date: 30 October 2012

Dear Applicant

This Feasibility Letter (Letter) is a guide only. It provides general information about what Sydney Water's requirements could be if you applied to us for a Section 73 Certificate (Certificate) for your proposed development. **The information is accurate at today's date only.**

If you obtain development consent for that development from your consent authority (this is usually your local Council) they will require you to apply to us for a Section 73 Certificate. You will need to submit a new application (and pay another application fee) to us for that Certificate by using your current or another Water Servicing Coordinator (Coordinator).

Sydney Water will then send you either a:

- Notice of Requirements (Notice) and Developer Works Deed (Deed) or
- Certificate.

These documents will be the definitive statement of Sydney Water's requirements.

There may be changes in Sydney Water's requirements between the issue dates of this Letter and the Notice or Certificate. The changes may be:

- if you change your proposed development eg the development description or the plan/site layout, after today, the requirements in this Letter could change when you submit your new application; and
- if you decide to do your development in stages then you must submit a new application

(and pay another application fee) for each stage.

What You Must Do To Get A Section 73 Certificate In The Future.

To get a Section 73 Certificate you must do the following things. You can also find out about this process by visiting www.sydneywater.com.au > Building and Developing > Developing Your Land.

1. **Obtain Development Consent from the consent authority for your development proposal.**
2. **Engage a Water Servicing Coordinator (Coordinator).**

You must engage your current or another authorised Coordinator to manage the design and construction of works that you must provide, at your cost, to service your development. If you wish to engage another Coordinator (at any point in this process) you must write and tell Sydney Water.

For a list of authorised Coordinators, either visit www.sydneywater.com.au > Building and Developing > Developing Your Land or call **13 20 92**.

The Coordinator will be your point of contact with Sydney Water. They can answer most questions that you might have about the process and developer charges and can give you a quote or information about costs for services/works (including Sydney Water costs).

3. **Developer Works Deed**

After the Coordinator has submitted your new application, they will receive the Sydney Water Notice and Developer Works Deed. You and your accredited Developer Infrastructure Providers (Providers) will need to sign and lodge both copies of the Deed with your nominated Coordinator. After Sydney Water has signed the documents, one copy will be returned to the Coordinator.

The Deed sets out for this project:

- your responsibilities;
- Sydney Water's responsibilities; and
- the Provider's responsibilities.

You must do all the things that we ask you to do in that Deed. This is because your development does not have sewer services and you must construct and pay for the following works extensions under this Deed to provide these services.

Note: The Coordinator must be fully authorised by us for the whole time of the agreement.

4. **Water and Sewer Works**

4.1 **Water**

Your development must have a frontage to a water main that is the right size and can be used for connection.

Sydney Water has assessed your application and found that:

- The existing 150mm DICL water main in Barnes Road is available to provide service to your proposed development.

4.2 Sewer

Your development must have a sewer main that is the right size and can be used for connection. That sewer must also have a connection point within your development's boundaries.

Sydney Water has assessed your application and found that:

- § Sydney Water will only accept connections to its wastewater system from rural developments when there is Council approval to develop and it is a condition of Council that a wastewater reticulation connection is required.
- § Details of the existing wastewater service for the property shall be submitted to Sydney Water as part of the Section 73 application.
- § Details of the proposed wastewater service for the property shall be submitted to Sydney Water for approval prior to development occurring.
- § A suitable connection point to accept the flows from the development will need to be provided.
- The wastewater main available for connection is the 150mm main traversing the property constructed under WO 300366.
- An accredited Hydraulic Designer will be engaged by the developer to ensure that the proposed wastewater infrastructure for this development will be sized & configured according to the Sewerage Code of Australia (Sydney Water Edition WSA 02-2002). Evidence of Code compliance should be attached with the design.
- Sydney Water is prepared to accept a pump to sewer service where the details generally include:

If the pumped point of entry into the sewer is via an inlet into an Access Chamber then the chamber must be plastic lined to prevent H₂S (Hydrogen Sulfide) corrosion.

Pump to sewer will be permitted at a rate of 2 l/s per property.

Where possible all pumped flows should enter the gravity sewers at a point where there is an upstream flow to help with flushing the pump flows. Sydney Water (SWC) operates under a licence that includes odours as an overflow. Applicants will be assessed on the basis of the application providing evidence that SWC licence will not be affected.

Discharge into the Collecting Access Chamber at point A. Refer to the plan below.

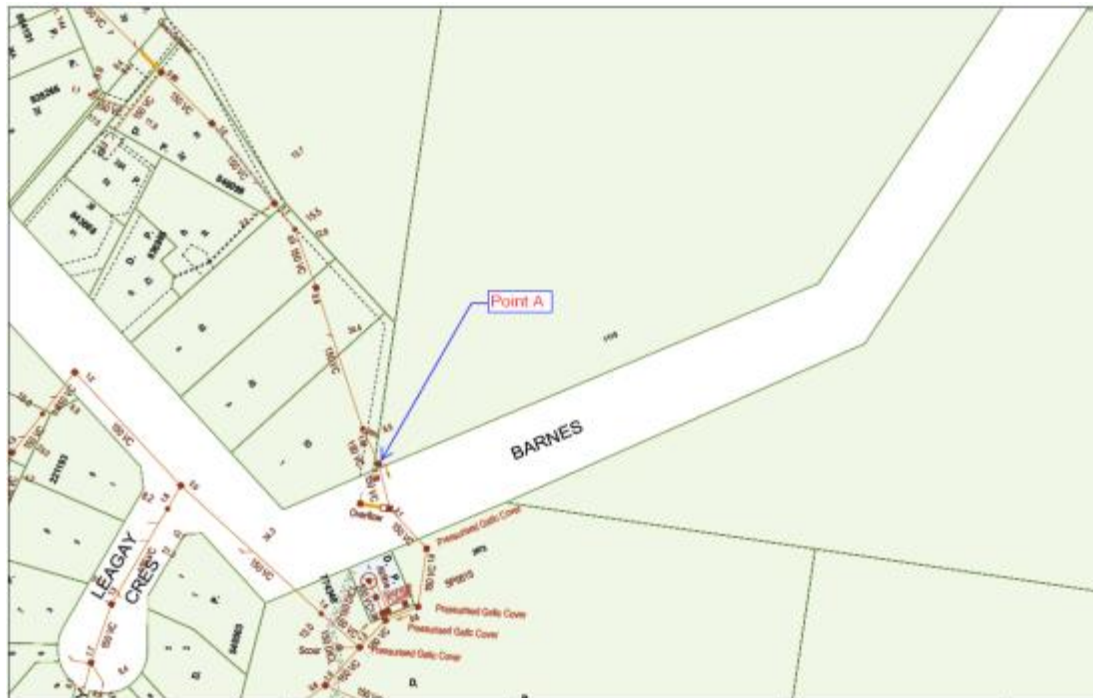

- **You must construct a waste water main extension to serve your development.** The terms of the Deed define this extension as 'Major Works'.

5. Ancillary Matters

5.1 Asset adjustments

After Sydney Water issues this Notice (and more detailed designs are available), Sydney Water may require that the water main/sewer main/stormwater located in the footway/your property needs to be adjusted/deviated. If this happens, you will need to do this work as well as the extension we have detailed above at your cost. The work must meet the conditions of this Notice and you will need to complete it **before we can issue the Certificate**. Sydney Water will need to see the completed designs for the work and we will require you to lodge a security. The security will be refunded once the work is completed.

5.2 Entry onto neighbouring property

If you need to enter a neighbouring property, you must have the written permission of the relevant property owners and tenants. You must use Sydney Water's **Permission to Enter** form(s) for this. You can get copies of these forms from your Coordinator or the Sydney Water website. Your Coordinator can also negotiate on your behalf. Please make sure that you address all the items on the form(s) including payment of compensation and whether there are other ways of designing and constructing that could avoid or reduce their impacts. You will be responsible for all costs of mediation involved in resolving any disputes. Please allow enough time for entry issues to be resolved.

5.3 Costs

Construction of these **future** works will require you to pay project management, survey, design and construction costs **directly to your suppliers**. Additional costs payable to Sydney Water may include:

- water main shutdown and disinfection;
- connection of new water mains to Sydney Water system(s);
- design and construction audit fees;
- contract administration, Operations Area Charge & Customer Redress prior to project finalisation;
- creation or alteration of easements etc; and
- water usage charges where water has been supplied for building activity purposes prior to disinfection of a newly constructed water main.

Note: Payment for any Goods and Services (including Customer Redress) provided by Sydney Water will be required prior to the issue of the Section 73 Certificate or release of the Bank Guarantee or Cash Bond.

Your Coordinator can tell you about these costs.

OTHER THINGS YOU MAY NEED TO DO

Shown below are other things you need to do that are NOT a requirement for the Certificate. They may well be a requirement of Sydney Water in the future because of the impact of your development on our assets. You must read them before you go any further.

Stamping and approval of your building plans

Please note that the building plans must be stamped and approved when each lot is developed. This can be done at a Quick Check agency. For an agency list visit www.sydneywater.com.au > Building and Developing > Quick Check or call 13 20 92).

This is not a requirement for the Certificate but the approval is needed because the construction/building works may affect Sydney Water's assets (e.g. water, sewer and stormwater mains).

Where a Sydney Water stormwater channel, pipe or culvert is located within ten (10) metres of your development site it must be referred to Sydney Water for further assessment.

Your Coordinator can tell you about the approval process including:

- Possible requirements;
- Costs; and
- Timeframes.

Disused Sewerage Service Sealing

Please do not forget that you must pay to disconnect all disused private sewerage services and seal them at the point of connection to a Sydney Water sewer main. This work must meet Sydney Water's standards in the NSW Code of Practice for Plumbing and Drainage (the Code) and be done by a licensed drainer. The licensed drainer must arrange for an inspection of the work by a NSW Fair Trading Plumbing Inspection Assurance Services (PIAS) officer. After that officer has looked at the work, the drainer can issue the Certificate of Compliance. The Code requires this.

Soffit Requirements

Please be aware that floor levels must be able to meet Sydney Water's soffit requirements for property connection and drainage.

Requirements for Business Customers for Commercial and Industrial Property Developments

If this property is to be developed for Industrial or Commercial operations, it may need to meet the following requirements:

Trade Wastewater Requirements

If this development is going to generate trade wastewater, the property owner must submit an application requesting permission to discharge trade wastewater to Sydney Water's sewerage system. You must wait for approval of this permit before any business activities can commence.

The permit application should be emailed to Sydney Water's Business Customer Services at businesscustomers@sydneywater.com.au

It is illegal to discharge Trade Wastewater into the Sydney Water sewerage system without permission.

A **Boundary Trap** is required for all developments that discharge trade wastewater where arrestors and special units are installed for trade wastewater pre-treatment.

If the property development is for Industrial operations, the wastewater may discharge into a sewerage area that is subject to wastewater reuse. Find out from Business Customer Services if this is applicable to your development.

Backflow Prevention Requirements

Backflow is when there is unintentional flow of water in the wrong direction from a potentially polluted source into the drinking water supply.

All properties connected to Sydney Water's supply must install a testable **Backflow Prevention Containment Device** appropriate to the property's hazard rating. Property with a high or medium hazard rating must have the backflow prevention containment device tested annually. Properties identified as having a low hazard rating must install a non-testable device, as a

minimum.

Separate hydrant and sprinkler fire services on non-residential properties, require the installation of a testable double check detector assembly. The device is to be located at the boundary of the property.

Before you install a backflow prevention device:

1. Get your hydraulic consultant or plumber to check the available water pressure versus the property's required pressure and flow requirements.
2. Conduct a site assessment to confirm the hazard rating of the property and its services. Contact PIAS at NSW Fair Trading on **1300 889 099**.

For installation you will need to engage a licensed plumber with backflow accreditation who can be found on the Sydney Water website:

<http://www.sydneywater.com.au/Plumbing/BackflowPrevention/>

Water Efficiency Recommendations

Water is our most precious resource and every customer can play a role in its conservation. By working together with Sydney Water, business customers are able to reduce their water consumption. This will help your business save money, improve productivity and protect the environment.

Some water efficiency measures that can be easily implemented in your business are:

- Install water efficiency fixtures to help increase your water efficiency, refer to WELS (Water Efficiency Labelling and Standards (WELS) Scheme, <http://www.waterrating.gov.au/>
- Consider installing rainwater tanks to capture rainwater runoff, and reusing it, where cost effective. Refer to <http://www.sydneywater.com.au/Water4Life/InYourBusiness/RWTCalculator.cfm>
- Install water-monitoring devices on your meter to identify water usage patterns and leaks.
- Develop a water efficiency plan for your business.

It is cheaper to install water efficiency appliances while you are developing than retrofitting them later.

Contingency Plan Recommendations

Under Sydney Water's [customer contract](#) Sydney Water aims to provide Business Customers with a continuous supply of clean water at a minimum pressure of 15meters head at the main tap. This is equivalent to 146.8kpa or 21.29psi to meet reasonable business usage needs.

Sometimes Sydney Water may need to interrupt, postpone or limit the supply of water services to your property for maintenance or other reasons. These interruptions can be planned or unplanned.

Water supply is critical to some businesses and Sydney Water will treat vulnerable customers, such as hospitals, as a high priority.

Have you thought about a **contingency plan** for your business? Your Business Customer Representative will help you to develop a plan that is tailored to your business and minimises productivity losses in the event of a water service disruption.

For further information please visit the Sydney Water website at: <http://www.sydneywater.com.au/OurSystemsandOperations/TradeWaste/> or contact Business Customer Services on **1300 985 227** or businesscustomers@sydneywater.com.au

Fire Fighting

Definition of fire fighting systems is the responsibility of the developer and is not part of the Section 73 process. It is recommended that a consultant should advise the developer regarding the fire fighting flow of the development and the ability of Sydney Water's system to provide that flow in an emergency. Sydney Water's Operating Licence directs that Sydney Water's mains are only required to provide domestic supply at a minimum pressure of 15 m head.

A report supplying modelled pressures called the Statement of Available pressure can be purchased through any Quickcheck agent and may be of some assistance when defining the fire fighting system. The Statement of Available pressure, may advise flow limits that relate to system capacity or diameter of the main and pressure limits according to pressure management initiatives. If mains are required for fire fighting purposes, the mains shall be arranged through the water main extension process and not the Section 73 process.

Large Water Service Connection

A water main are available to provide your development with a domestic supply. The size of your development means that you will need a connection larger than the standard domestic 20 mm size.

To get approval for your connection, you will need to lodge an application with a Quick Check Agent. You, or your hydraulic consultant, may need to supply the following:

- A plan of the hydraulic layout;
- A list of all the fixtures/fittings within the property;
- A copy of the fireflow pressure inquiry issued by Sydney Water;
- A pump application form (if a pump is required);
- All pump details (if a pump is required).

You will have to pay an application fee.

Sydney Water does not consider whether a water main is adequate for fire fighting purposes for your development. We cannot guarantee that this water supply will meet your Council's fire fighting requirements. The Council and your hydraulic consultant can help.

Disused Water Service Sealing

You must pay to disconnect all disused private water services and seal them at the point of

connection to a Sydney Water water main. This work must meet Sydney Water's standards in the NSW Code of Practice for Plumbing and Drainage (the Code) and be done by a licensed plumber. The licensed plumber must arrange for an inspection of the work by a NSW Fair Trading Plumbing Inspection Assurance Services (PIAS) officer. After that officer has looked at the work, the drainer can issue the Certificate of Compliance. The Code requires this.

Other fees and requirements

The requirements in this Notice relate to your Certificate application only. Sydney Water may be involved with other aspects of your development and there may be other fees or requirements. These include:

- plumbing and drainage inspection costs;
- the installation of backflow prevention devices;
- trade waste requirements;
- large water connections and
 - council fire fighting requirements. (It will help you to know what the fire fighting requirements are for your development as soon as possible. Your hydraulic consultant can help you here.)

No warranties or assurances can be given about the suitability of this document or any of its provisions for any specific transaction. It does not constitute an approval from Sydney Water and to the extent that it is able, Sydney Water limits its liability to the reissue of this Letter or the return of your application fee. You should rely on your own independent professional advice.

END